



# 150mm Palm Air Sander

Powerful Air Sanders with orbital motions and low air consumption. Ready for use with its own portable dust bag, central vacuum system or stand-alone.



**Part N°:** A1369 = 5 mm orbit  
A1370 = 2.5mm orbit  
A1372 = Dust Hose & Bag  
A1373 = Lubricant

## Features

- Direct hook-up to a central system or own dust bag
- Adjustable motor speed
- Easy to handle
- Powerful air motor with low air consumption
- Operating Pressure 90psi (6.3 kg/cm<sup>2</sup>)

## Benefits

- Versatile with low air consumption
- Adapts to every surface preparation
- Can be used in areas where no central vacuum supply without dust contamination

## Applications

Orbital Air Sanders, ready to use with any central or portable vacuum system, but also stand-alone with its own dust bag, or with no vacuum. With its light weight and smooth operation is easy to master while providing the power and flexibility you need.

The Dust Bag A1372 is a cost effective alternative for workplaces without a central or portable vacuum system. The Sander self-generates a vacuum to remove dust to the bag.

The Sanders cover all applications with all 150mm grit grades

## Instructions

1. Ensure the Sander is connected to the central or portable system OR own bag OR standalone
2. Check Operating Pressure (90 psi/).
3. Place the Abrasive on the Pad size selected.
4. Commence Sanding.



## Technical Information

<b>Description:</b>	Orbital action Palm Air Sanders	<b>Min. hose size in (mm):</b>	1/4" (6.35)
<b>weight:</b>	0.96Kg (A1369); 0.93Kg (A1370)	<b>Pad Model Size:</b>	152mm 6 inches
<b>Selling Unit:</b>	each	<b>Orbit Action:</b>	5mm and 2.5mm
<b>Accessories:</b>	Dust Bag/Hose: Lubricant	<b>Air Consumption:</b>	6.7 Ft <sup>3</sup> /m 190L/m
<b>Customs Tariff code:</b>	84671110		
<b>Air Pressure PSI (BAR):</b>	90 (6.3) Approx		
<b>Motor Free Speed :</b>	10,000 rpm @ 90 PSI (6 Bar)		
<b>Vacuum Mode:</b>	Central system; self-generated OR none		
<b>Air Inlet: in (mm) :</b>	1/4" (6.35)		



SDS available on [www.kenturope.com](http://www.kenturope.com)

### Terms and Conditions

No part of this publication may be reproduced, transmitted or stored, electronically, mechanically or photocopied without the prior permission of KENT (United Kingdom) Ltd. This data sheet and its contents (the "Information") belong to the KENT (United Kingdom) Ltd or are licensed to it. No license is granted for the use of it other than for information purposes in connection with the products to which it relates. No license of any intellectual property rights is granted.

The Information is subject to change without notice and replaces all data sheets previously supplied. The Information supplied is believed to be accurate but the Group assumes no responsibility for its accuracy or completeness, any error from or omission in it nor for any use made of it. Users of this data sheet should check for themselves the Information and the suitability of the products for their purpose and not make any assumptions based on information included or omitted. Liability for loss or damage resulting from any reliance on the Information or use of it (including

liability resulting from negligence or where the Group was aware of the possibility of such loss or damage arising) is excluded. This will not operate to limit or restrict the Group's liability for death or personal injury resulting from its negligence KENT is the trading name of KENT (United Kingdom) Ltd

**Registered Office:** Amber House, Showground Road, Bridgewater, Somerset, United Kingdom, TA6 6AJ  
All rights reserved.

**KENT (United Kingdom) Ltd, Forsyth House, Pitreavie Drive, Pitreavie Business Park, Dunfermline, Fife, KY11 8US**  
**Tel :** 0800 136925 or 01383 723344 between 08:30-17:30 Monday-Thursday, 09:00-15:00 on Fridays.  
For out of hours queries please **Fax** us on 01383 735829 or **Email:** [kentinfo.uk@kenturope.com](mailto:kentinfo.uk@kenturope.com)

Rev: 18/07/2017



## Instructions for use

### INTRODUCING 3-in-1

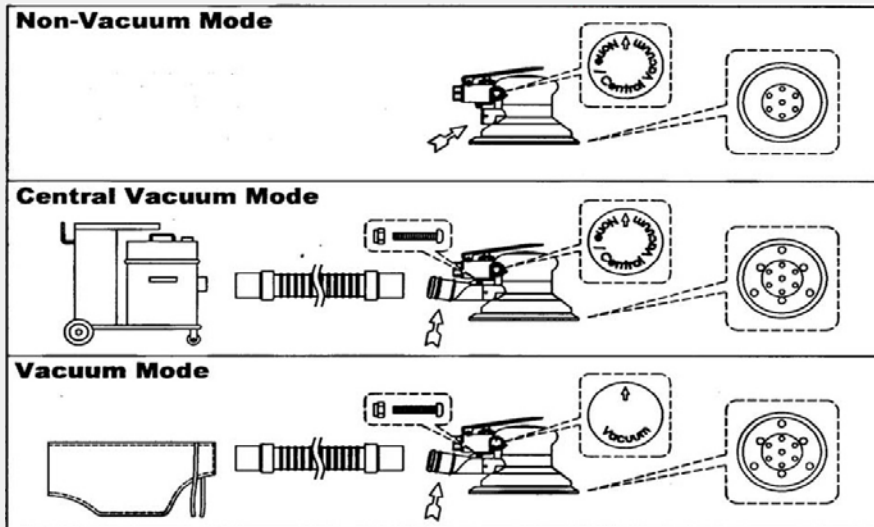

#### Turning Adjustment (fig.1)

The motor speed can be freely adjusted to meet different jobs.

#### Air Supply Requirements (fig. 2)

- For best performance and maximum durability of parts, operating air pressure must be set at **90PSI (6.2Kg/cm<sup>2</sup>)** maximum at the inlet.
- Connect tool to airline using pipe, hose and fitting sizes shown as the diagram.

#### Notice

- Keep hand and clothing away from the moving sand pad.
- Do not wear loose clothing or jewelry and be sure that hair is properly restrained.
- Release inlet air pressure before changing the pad.

#### Lubrication (fig. 3)

Use an air line lubricator (#KENT product? or SAE #10 oil) adjusted to 2 drops per minute, or lubricate into air inlet daily before and after operation.

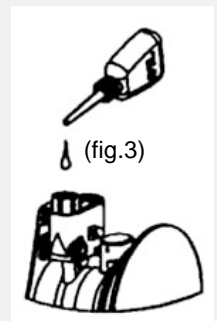
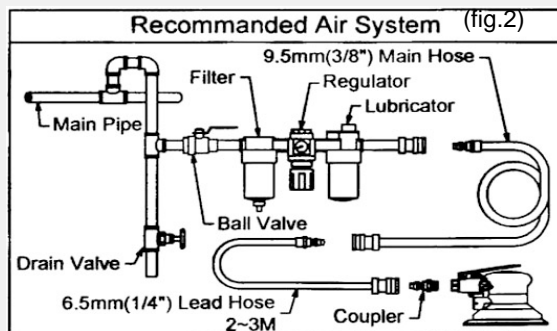
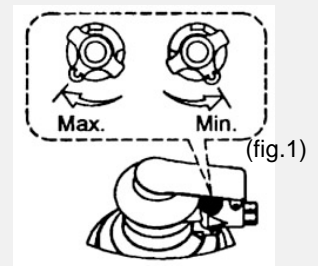



**!! WARNING !!**

Carefully read and understand all instructions before work starts to reduce risk of injury/damage to operator(s) and tool.

This product is not subject to identification regulations under EC Directives and the Ordinance on Hazardous Materials.

# 3-in-1 Random Orbital Palm Sander

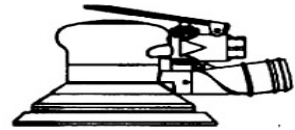

Exchange between Non-Vac. / Central Vac. and Vacuum modes

**Step 1**

It works easily to twist the left and right sides slightly when pulling out.

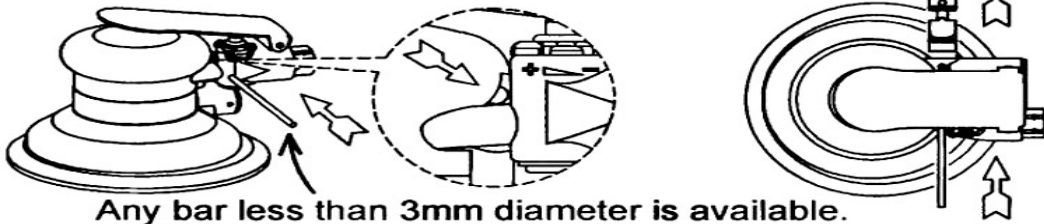

**Step 2**

It works easily to twist the left and right sides slightly when pushing on.

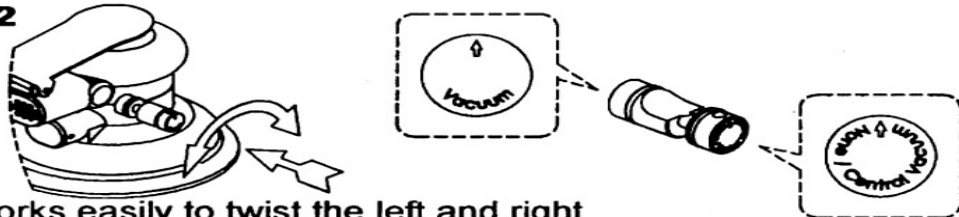

**Step 3**

Steel ball

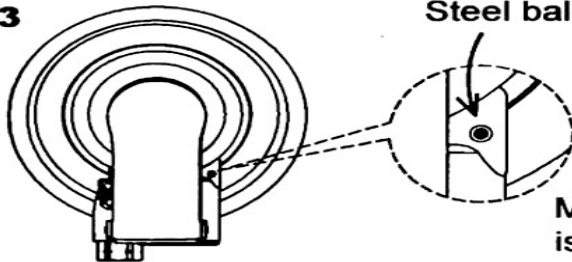

Make sure the steel ball is in the location hole.